

Giti
Belvista
Discover a beautiful life

**BLESSED WITH
BEAUTIFUL LIVING**



Giti
Belvista
Discover a beautiful life



DISCOVER A LUXURIOUS
LIFESTYLE

*Artistic impression



Gin
Belvista
Discover a beautiful life

DISCOVER THE PERFECTION
IN EVERY DETAIL

*Artistic impression



Legal Note: Project will be developed in multiple phases, presently Phase 1 & 2 are registered under MahaRera

*Artistic impression

MASTER LAYOUT @ GINI BELVISTA

LEGEND

- 1. MAIN ENTRANCE
- 2. WATER BODY
- 3. SIT OUT
- 4. CLUB HOUSE
- 5. BUFFET AREA

- 6. PATHWAY
- 7. SANDPIT AREA
- 8. KIDS' PLAY AREA
- 9. PARTY LAWN
- 10. YOGA, MEDITATION AREA
- 11. STAGE

- 12. SWIMMING POOL
- 13. DECK AREA
- 14. FEATURE WALL
- 15. MULTIPURPOSE COURT
- 16. GUEST BEDROOMS
- 17. CO-WORKING SPACES



**DISCOVER
FINEST
PLANNING**



*Artistic Impression

◀ **DISCOVER**
THE JOYFUL
SURROUNDINGS
CLUBHOUSE + PLAY AREA



*Artistic Impression

◀ **DISCOVER**
EASE OF
SHOPPING
SHOPS



DISCOVER ▶
A PARADISE
FOR KIDS
KIDS ZONE



*Artistic impression

DISCOVER ▶
THE REFRESHING
LEISURES
AQUA ZONE



*Artistic impression



*Artistic impression

◀ **DISCOVER**
ABUNDANT
CHOICES
CLUB HOUSE



*Artistic impression

◀ **DISCOVER**
THE FREEDOM TO
WORK WITHOUT
DISTURBANCE
CO-WORKING SPACES



DISCOVER THE FLAVOURS OF LIFE

LIFESTYLE AMENITIES @ GINI BELVISTA

CLUB HOUSE | SWIMMING POOL WITH DECK
MULTIPURPOSE PLAY COURT | BUFFET AREA | PARTY
LAWN | KIDS' PLAY AREA | WATER BODIES
YOGA & MEDIATION AREA | SENIOR CITIZEN AREA



LIFESTYLE FEATURES @ GINI BELVISTA



ELECTRIFICATION

- Concealed Electrical Piping
- Renowned Modular Switches
- Standard ISI Multi-strand Wires with MCB & ELCB
- Provision for AC Point in Master Bedroom
- TV and Telephone Points in Master Bedroom & Living Room



UTILITIES

- Sewage Treatment Plant
- Organic Waste Converter
- Rainwater Harvesting
- Water Recycling for Garden and Flushing
- Generator Backup for Common Passages & Utilities
- Provision for Inverter in Each Apartment
- Underground and Overhead Tanks for Water Storage
- Firefighting System
- Tremix Concrete Roads
- Anti-termite Treatment for Building structure



FLOORING

- Wooden Finish Tiles in Master Bedroom
- Vitrified Tiles in rest of the Apartment
- Dado Tiles for Bathrooms and Kitchen
- Anti-skid Tiles for Bathrooms & Terraces



WINDOWS

- Black Granite Window Sill
- Window Grills
- Aluminum Windows with Mosquito Net
- Aluminum Sliding Doors for Terraces



DOORS

- Modular/Laminated Doors with CP Fittings



R.C.C.

- Structure Designed with Earthquake Resistant Frame



KITCHEN

- Marble / Granite Platform
- Stainless Steel Sink
- Dado Tiles up to 4' Height
- Provision for Exhaust Fan
- Provision for Water Purifier
- Provision for Washing Machine in Dry Balcony



BATHROOMS/TOILETS

- Concealed Plumbing
- Single Lever Diverter
- Health Faucet
- Bathroom Glazing up-to 7' Height
- Black Granite Door Frames
- Solar Heated Water for Master Bathroom
- Provision for Electric Geyser
- Provision for Exhaust Fan



WALL FINISH / PAINT

- P O P/ Gypsum Wall Finish
- O B D Paint for Interiors
- Acrylic Emulsion Paint for Exteriors



SECURITY

- Video Door Phone for Each Apartment
- CCTV Cameras for Selected Areas
- Security Cabin



AREA STATEMENT

FLAT NO.	FLAT TYPE	CARPET AREA				TOTAL CARPET AREA (SQ.M.)	TOTAL CARPET AREA (SQ.FT.)
		FLAT CARPET	ENCL. BALC CARPET	DRY TERRACE CARPET	TERRACE CARPET		
201,401,601	2 BHK	44.82	6.20	1.62	5.05	57.69	621.00
202,402,602	2 BHK	51.27	6.70	3.14	6.15	67.26	724.00
203,403,603	2 BHK	51.27	6.70	3.14	6.15	67.26	724.00
204,404,604	2 BHK	44.97	6.05	1.62	5.05	57.69	621.00
205,405,605	2 BHK	44.82	6.20	1.62	5.05	57.69	621.00
206,406,606	2 BHK	51.27	6.70	3.14	6.15	67.26	724.00
207,407,607	2 BHK	51.40	6.57	3.14	6.15	67.26	724.00
208,408,608	2 BHK	44.82	6.20	1.62	5.05	57.69	621.00
209,409,609	2.5 BHK	63.64	9.37	2.20	5.21	80.42	865.00
210,410,610	2.5 BHK	63.64	9.37	2.20	5.21	80.42	865.00

- Disclaimer:
- The area in Sq. Ft. has been mentioned just for the convenience of the customer for better understanding.
 - The arrangement of furniture is just shown for purpose of layout and it's not part of offer/sale.
 - The dimensions given in feet and inches are rounded to nearest precision.

KEY PLAN

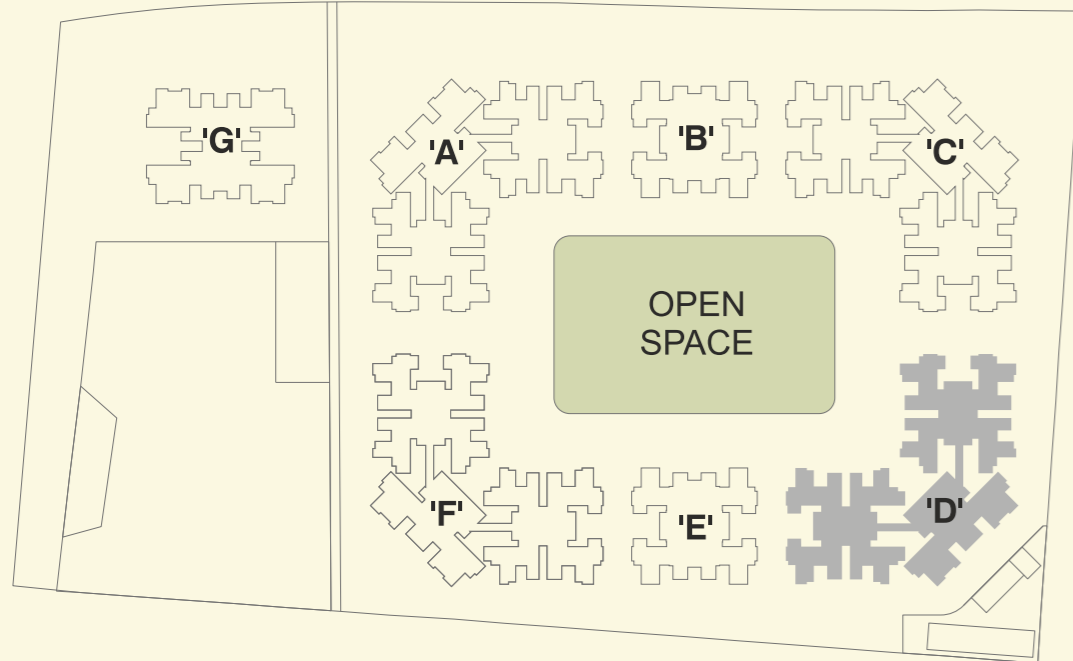

D-WING
TYPICAL FLOOR PLAN
(2ND, 4TH & 6TH)

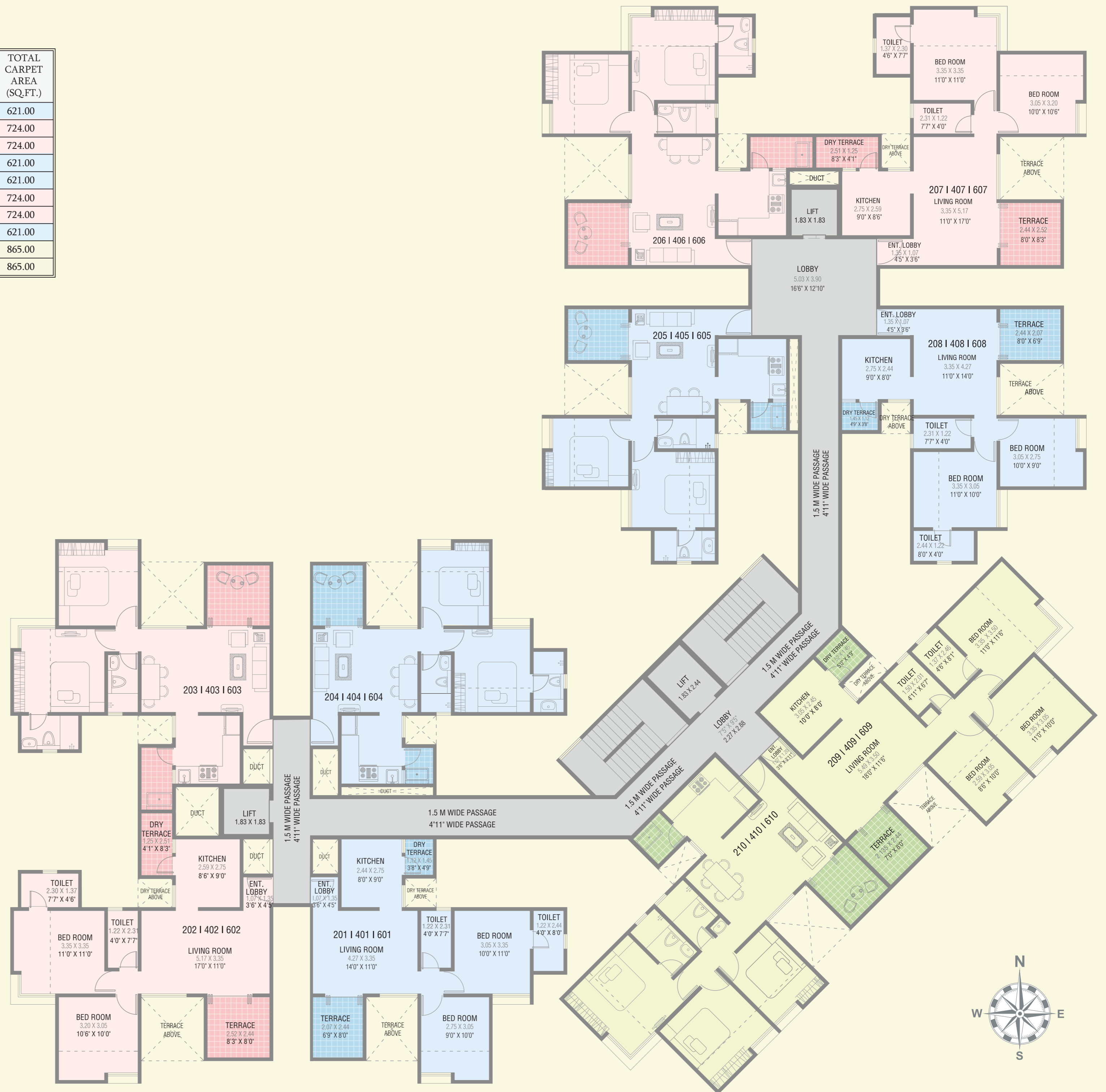

AREA STATEMENT

FLAT NO.	FLAT TYPE	CARPET AREA				TOTAL CARPET AREA (SQ.M.)	TOTAL CARPET AREA (SQ.FT.)
		FLAT CARPET	ENCL. BALC CARPET	DRY TERRACE CARPET	TERRACE CARPET		
301,501,701,901	2 BHK	48.63	2.39	1.62	5.05	57.69	621.00
302,502,702,902	2 BHK	51.27	6.70	2.32	6.15	66.44	715.00
303,503,703,903	2 BHK	51.27	6.70	2.32	6.15	66.44	715.00
304,504,704,904	2 BHK	45.67	5.35	1.62	5.05	57.69	621.00
305,505,705,905	2 BHK	45.52	5.50	1.62	5.05	57.69	621.00
306,506,706,906	2 BHK	51.27	6.70	2.32	6.15	66.44	715.00
307,507,707,907	2 BHK	51.40	6.57	2.32	6.15	66.44	715.00
308,508,708,908	2 BHK	45.52	5.50	1.62	5.05	57.69	621.00
309,509,709,909	2.5 BHK	57.57	15.44	2.20	5.21	80.42	865.00
310,510,710,910	2.5 BHK	63.64	9.37	2.20	5.21	80.42	865.00

Disclaimer:
 • The area in Sq. Ft. has been mentioned just for the convenience of the customer for better understanding.
 • The arrangement of furniture is just shown for purpose of layout and it's not part of offer/sale.
 • The dimensions given in feet and inches are rounded to nearest precision.

KEY PLAN

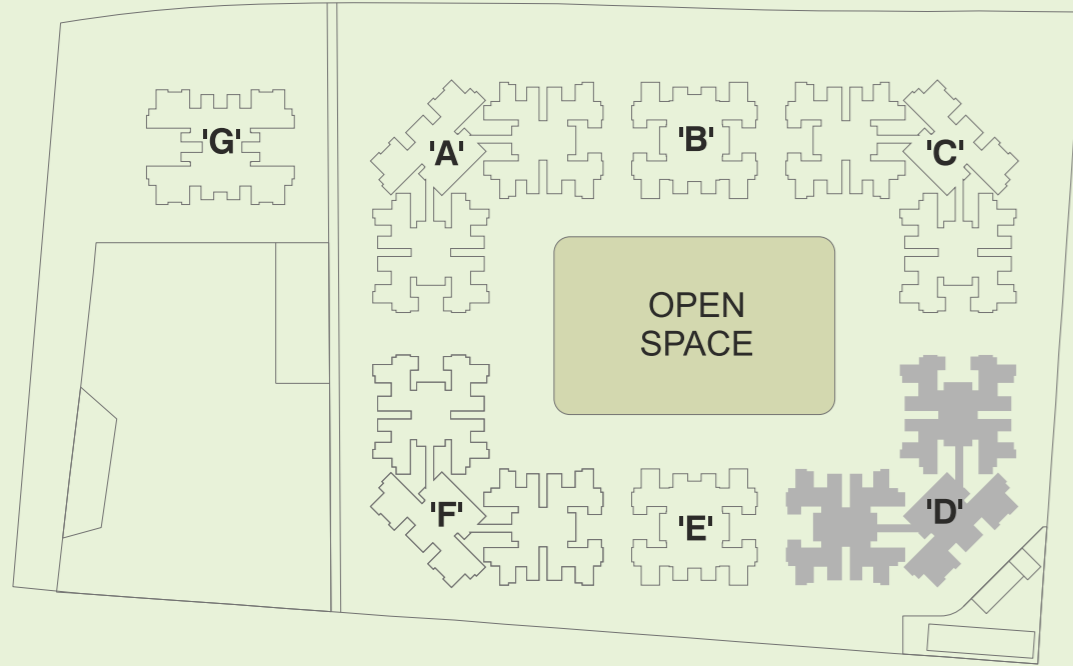

D-WING
 TYPICAL FLOOR PLAN
 (3RD, 5TH, 7TH & 9TH)

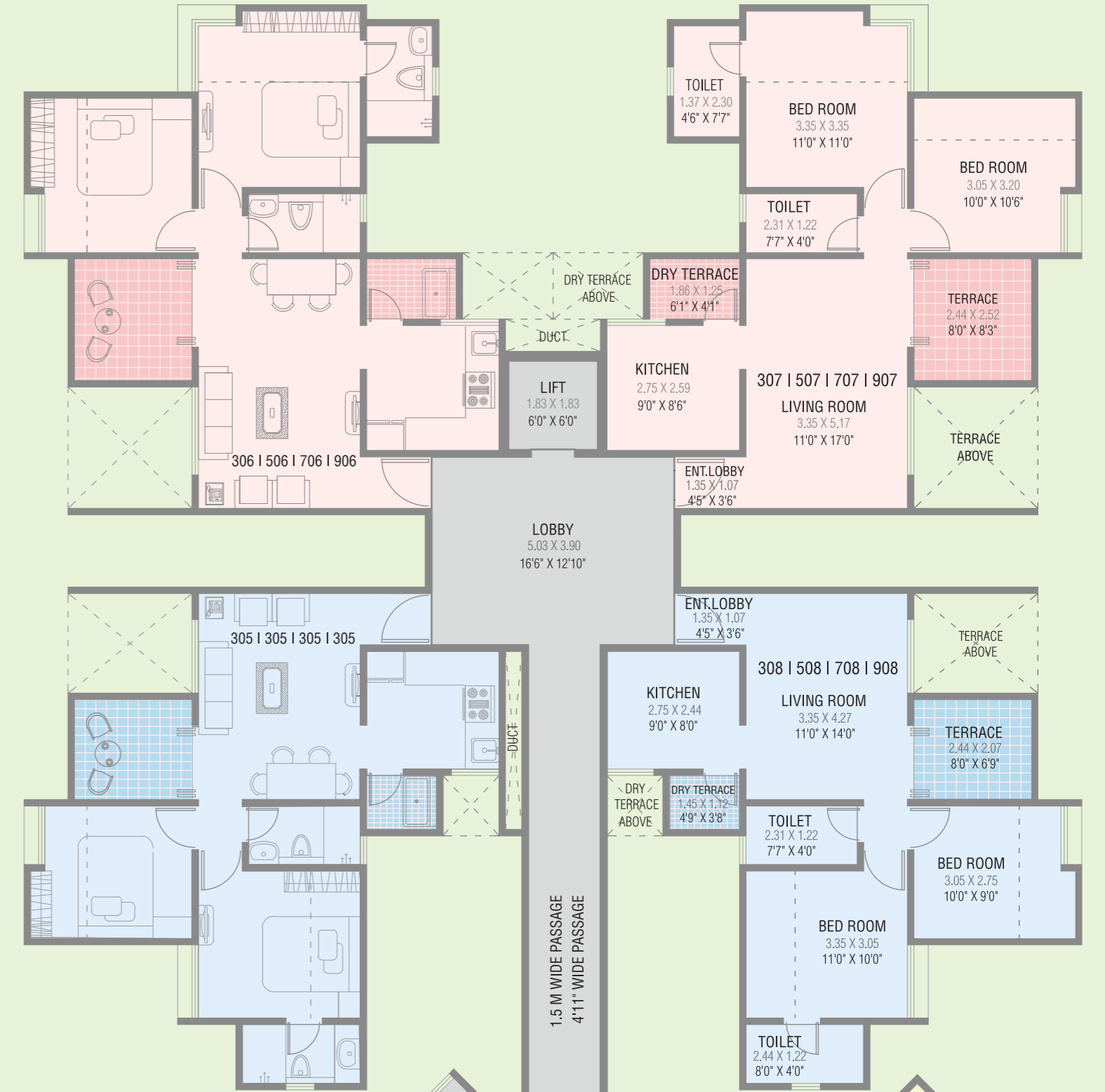

AREA STATEMENT

FLAT NO.	FLAT TYPE	CARPET AREA				TOTAL CARPET AREA (SQ.M.)	TOTAL CARPET AREA (SQ.FT.)
		FLAT CARPET	ENCL. BALC CARPET	DRY TERRACE CARPET	TERRACE CARPET		
801	2 BHK	44.82	6.20	1.62	5.05	57.69	621.00
802	2 BHK	51.27	6.70	3.14	6.15	67.26	724.00
803	2 BHK	51.27	6.70	3.14	6.15	67.26	724.00
804	2 BHK	44.97	6.05	1.62	5.05	57.69	621.00
805	2 BHK	44.82	6.20	1.62	5.05	57.69	621.00
806	2 BHK	51.27	6.70	3.14	6.15	67.26	724.00
807	2 BHK	51.40	6.57	3.14	6.15	67.26	724.00
808	2 BHK	44.82	6.20	1.62	5.05	57.69	621.00
809	REFUGE AREA						
810	2.5 BHK	63.64	9.37	2.20	5.21	80.42	865.00

Disclaimer:

- The area in Sq. Ft. has been mentioned just for the convenience of the customer for better understanding.
- The arrangement of furniture is just shown for purpose of layout and it's not part of offer/sale.
- The dimensions given in feet and inches are rounded to nearest precision.

KEY PLAN

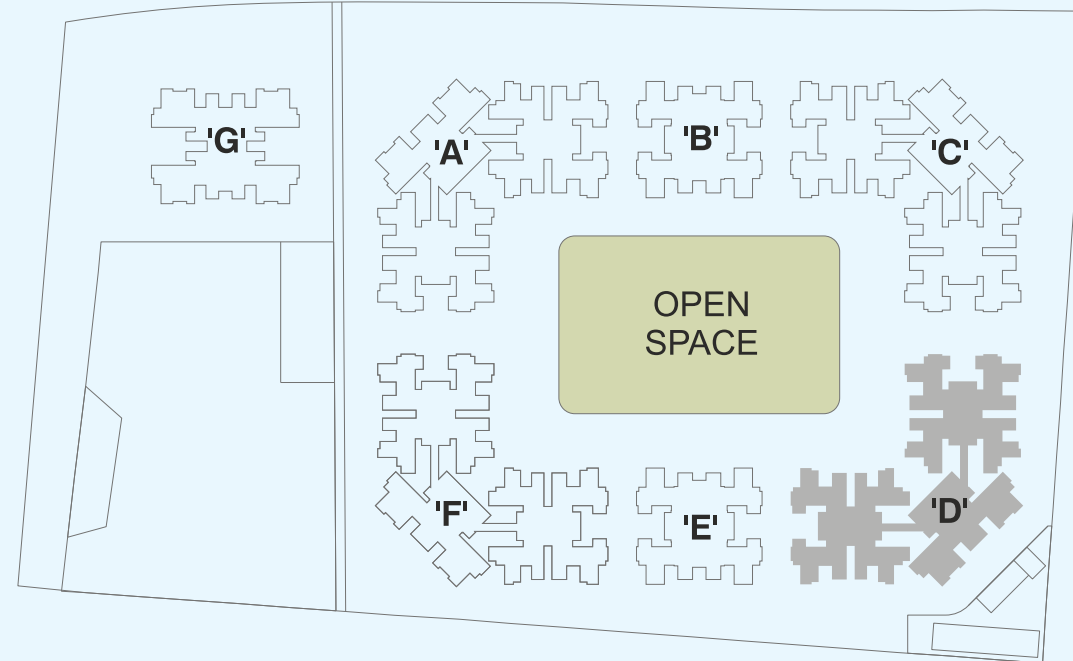

D-WING

EIGHTH FLOOR PLAN

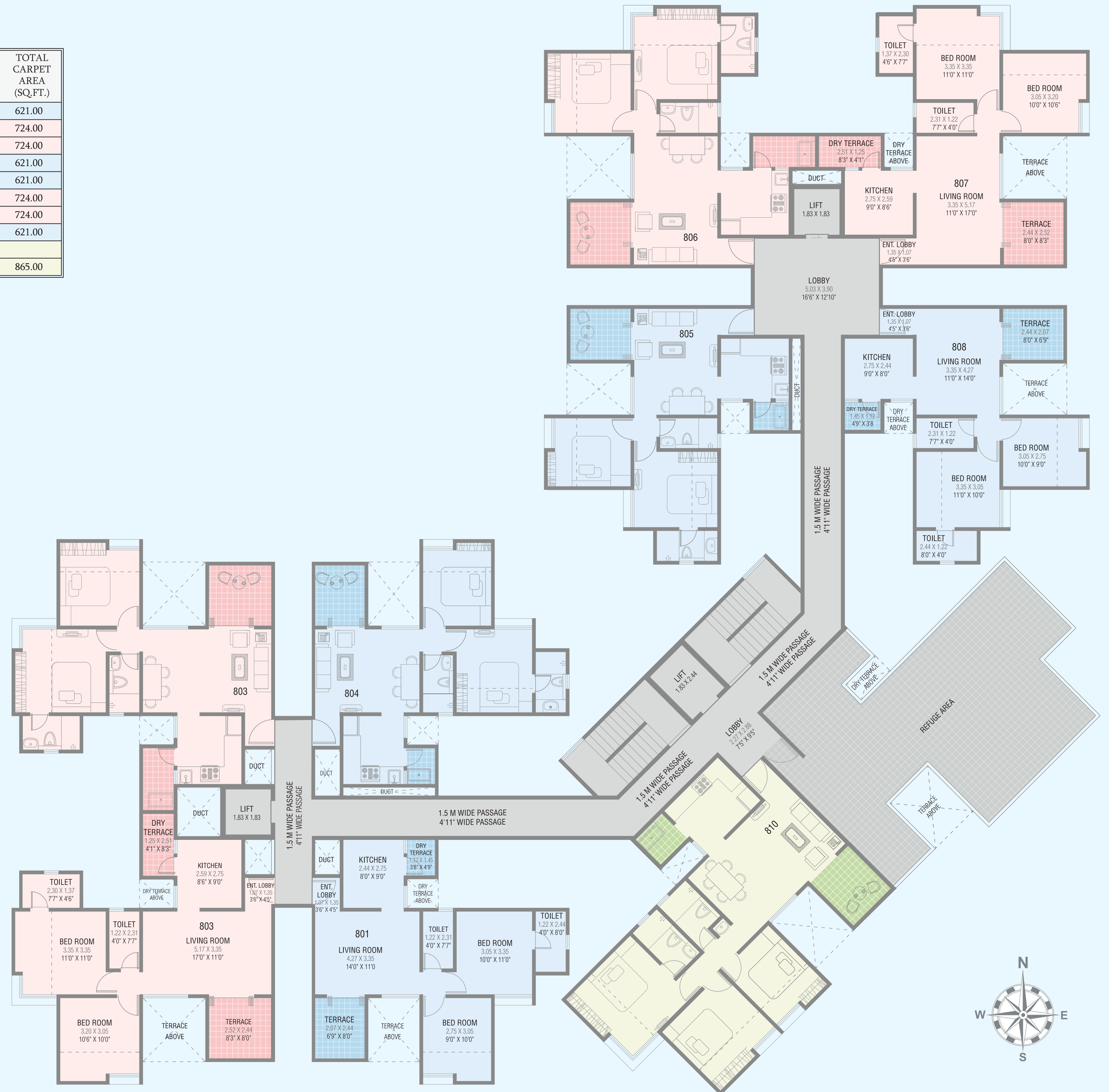

OUR STORY

We have come a long way. We have a long way to go.



Inception of Gini Fabrics by Mr Vishwanath Harlalka

1963



Inauguration of our first Textile Process House in Yersova

1981



Second generation joins the family business

1984



Expansion of Gini Pan India

1988



Gini Goes Public

1996



Diversification into Real Estate Business

2001



Gini Plaza @ Panvel

2004



Expansion of Real Estate in Pune.

2005



Gini Sanskruti @ Hadapsar - Pune

2007



Gini Bellissimo @ Dhanori - Pune

2009



Gini Bellina @ Lohegaon - Pune

2011



Creation RG

2011



Gini Lake Gardenz @ Ahmedabad

2012



Gini Viviana @ Balewadi - Pune

2012



50 Years of Gini Group

2013



Harlalka Heights @ Mumbai

2014



3rd Generation Pranav Harlalka | Karan Harlalka

2018



Gini Aria @ Yewlewadi - Pune

2018



Creation Of GIB INSTITUTIONAL BUSINESS

2019



Gini Belvista @ Dhanori - Pune

2019



Gini Kiwale - Pune

Coming Soon

LOCATION MAP
Not to scale



TRANSPORT

Pune Airport - 4.5 Km.
Vishrantwadi - 6.5 Km.
Kalyani Nagar - 8.5 Km.
Pune Station - 11.5 Km.



HOSPITAL

Orchid Hospital - 1.5 Km.
Sparsh Orthopaedic - 1.0 Km.
Patil Hospital - 2.0 Km.
Shree Hospital - 3.5 Km.



IT COMPANIES

Commerzone - 8.0 Km.
Panchshil Tech Park One - 7.5 Km.
Business Bay - 8.0 Km.
Eon IT Park - 12.0 Km.
World Trade Center - 12.0 Km.
Magarpatta City - 14.5 Km



RETAIL

Big Bazar - 7 Km.
Phoenix Mall - 8 Km.
Pulse Mall - 8 Km.
Inorbit Mall - 8.5 Km.



EDUCATION

D Y Patil - 1.5 Km.
St. Peters School - 2.0 Km.
Dr. Mar Theophilus School - 2.0 Km.
Pune International School - 5.0 Km.
Indian Institute of Architects - 5.0 Km.

- A PROJECT BY -



&



SITE ADDRESS

Survey No.11/1 Part, D. N. Parande Park, Near Porwal Road, Dhanori Pune - 411015

ADMIN OFFICE

3E, Gulmohar Apartment, 1st Floor, C Wing, 2420, East Street, Camp, Pune 411 001.
Admin Office Contact No.:+9120 48617192 Email Id: pune@giniconstructions.com

CORPORATE OFFICE

421 Jogani Industrial Premises, Off. N. M. Joshi Marg, Lower Parel (E), Mumbai - 400 011.

For bookings contact: 7538 000 333, 7538 000 444

email: belvista.sales@giniconstructions.com | www.giniconstructions.com

C R E D I T S

ARCHITECTS



R.C.C. CONSULTANTS



LANDSCAPE DESIGNER



This brochure is purely conceptual and not a legal offering. The developer reserves all the rights to add, delete, alter any detail, specifications, elevation mentioned herein. The brochure is indicative of how the furniture can be arranged in the residential unit. No furniture is to be supplied to the purchaser by the developer unless otherwise mentioned. All images, unless otherwise indicated are used for illustrative purpose only.



Phase 1 - R. NO. : P52100018898
Phase 2 - R. NO. : P52100027381
<https://maharera.mahaonline.gov.in>

